

PC 6300 - IX

AUTOMATIC LEG BOTTOM HEMMING AUTOMAT



Website



Youtube

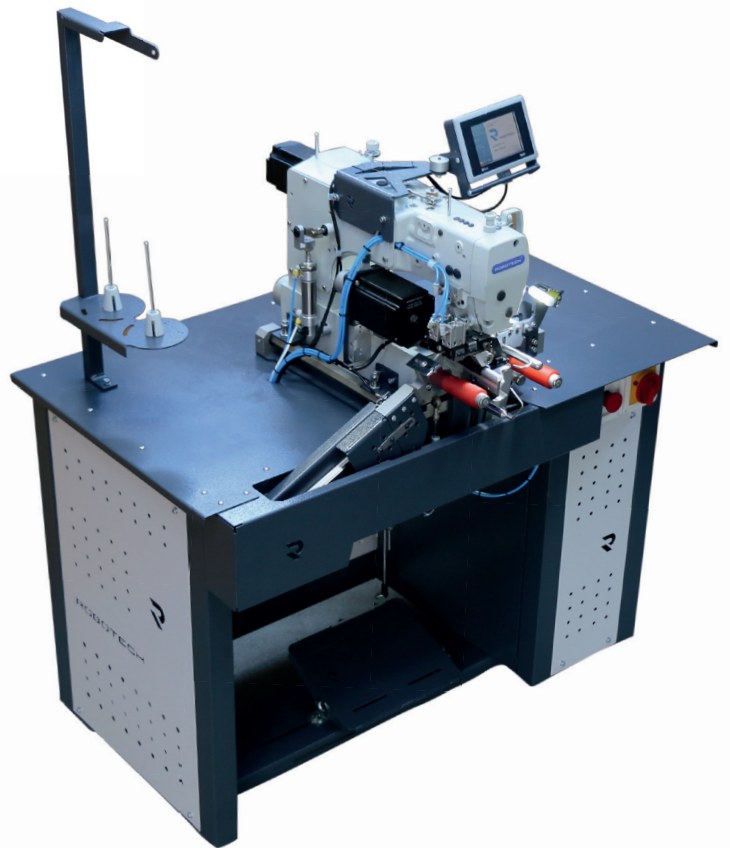

PERFORMANCE

438 - 500 trouser bottoms / 1 hour

3500 - 4000 trouser bottoms / 8 hours

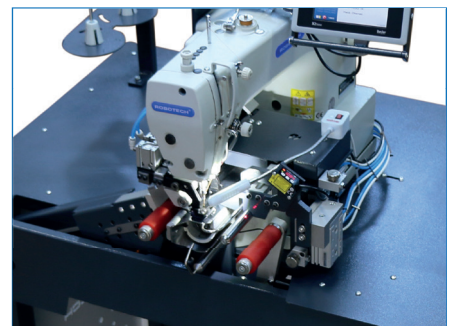
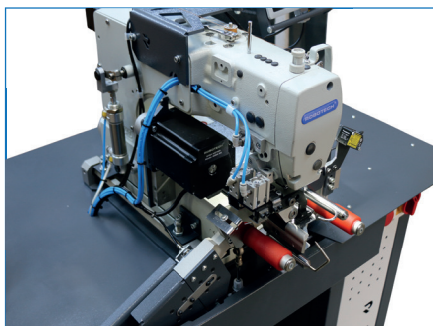
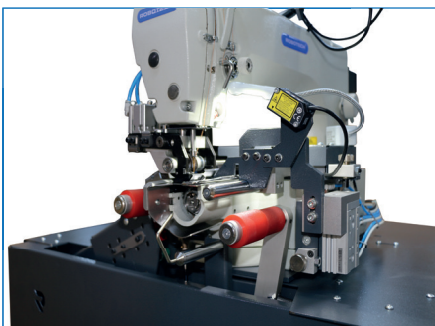

Full- Automatic Bottom Hemming Machine PC 6300 - IX For Jeans, Casual pants, Working pants, etc. Self-compensating fabric tension mechanism adjusts inconsistencies in hemming diameter. Accurate start and finish of sewing by sensor provides exact positioning of hem joint. Overlapping of hem joint start and finish seam can be programmed from control panel. Operators can focus on next piece while the machine is sewing. It can improve productivity and release working pressure. The sewing head design allows converting the machine from Metal gear to plastic gear or pallet Puller system and vice versa, in case of changing fabric quality. No need to buy a new machine. With some additional parts and a couple minutes of adjusting and you are ready to work on different fabrics.

Adjustable stitch length from control panel eliminates the need for mechanical change of gears. Adjustable stitch edge inside of the hem.

TECHNICAL SPECIFICATIONS

- Lock stitch direct drive sewing head
- **Beijer Electronics**, Windows Based 256 million colour supported touch screen
- Control panel, with images, easy to use, with 50 different programming
- Makes working on different cuff sizes in order / by cycle programming
- PLC control unit
- With 750 W motor controlled upper pulling palette-transport system
- Sensor system to detect the thickness of fabric automatically
- Through the panel programmable condensing stitch and stitch-length at stitch-start and stitch-end
- With the assistance of the sensor, ability to perform very sensitive work from the panel, detects the start-finish across the hem joint
- Possibility of folding and sewing between 135 mm – 500 mm trouser leg bottoms
- Automatic thread cutting at the end of stitch and cleaning system
- Automatic foot lifting
- Error detecting systems
- Thread monitor

OPTIONS

- Medium Size Metal Gear for Thick Fabrics
- Large Teeth Metal Gear for Thick Fabrics
- Short Fabric Catcher Hook

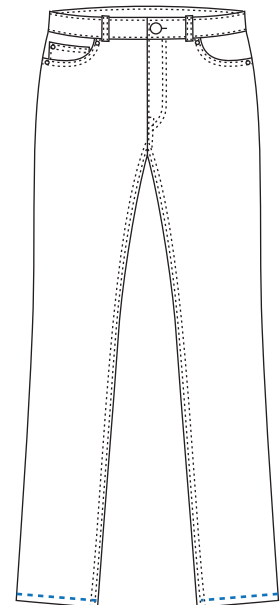

TECHNICAL DETAILS

Max. Sewing Speeds : 3.500 r.p.m
 Max. Stitch Length : 1 or 10 mm
 Stitch type : 301 (Lockstitch)
 Connection Voltage: AC 230 V, 50/60 Hz
 Air Pressure : 6 bar

DIMENSIONS

L: 110 cm / W: 65 cm / H: 125 cm
 Packing Size : 127 cm x 89 cm x 145 cm
 Machine Net Weight : approx. 150 kg
 Machine Gross Weight : approx. 180 kg

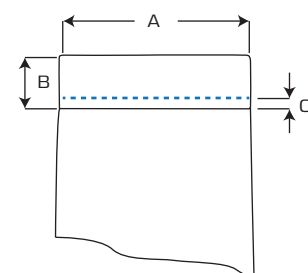
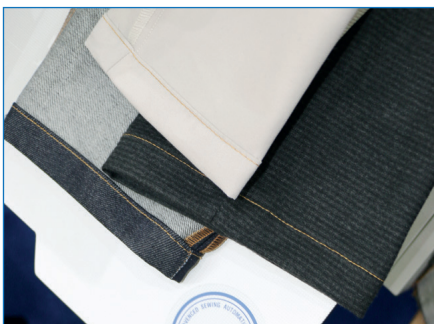

A = min. 13,5 cm - max. 50 cm
 B = min. 1 cm - max. 4 cm
 C = min. 2 mm - max. 7 mm